

The background features a large black triangle in the upper right, a white triangle in the lower left, and a gray triangle in the bottom right corner. The text is centered in the white area.

# Minggu 12

## Perancangan Arsitektur 2

- Pengembangan integrasi skematik desain ruang luar bangunan dengan prinsip-prinsip SED.
- Merencanakan interior bangunan (parsial)

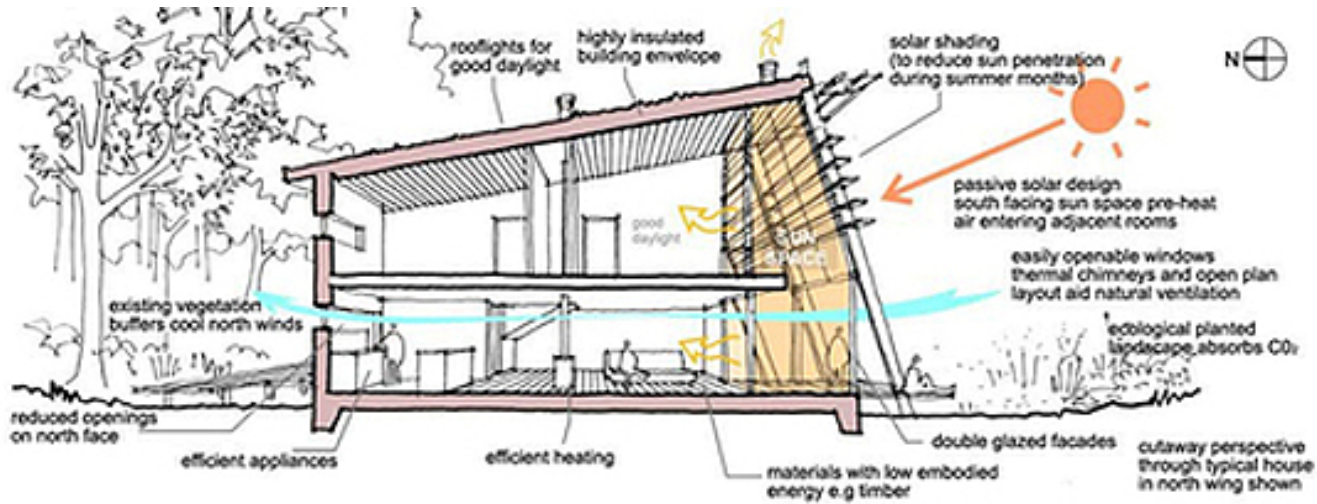

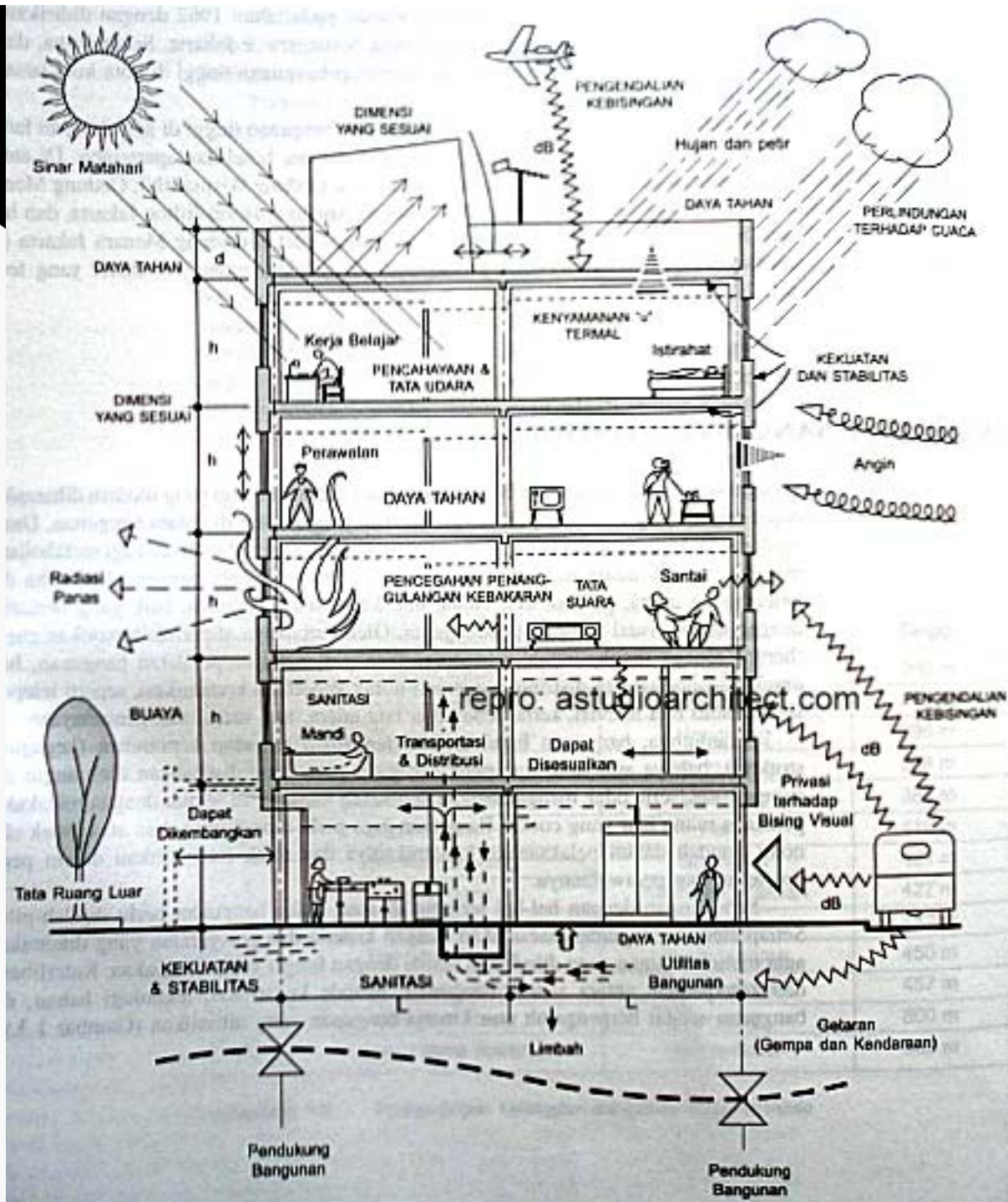

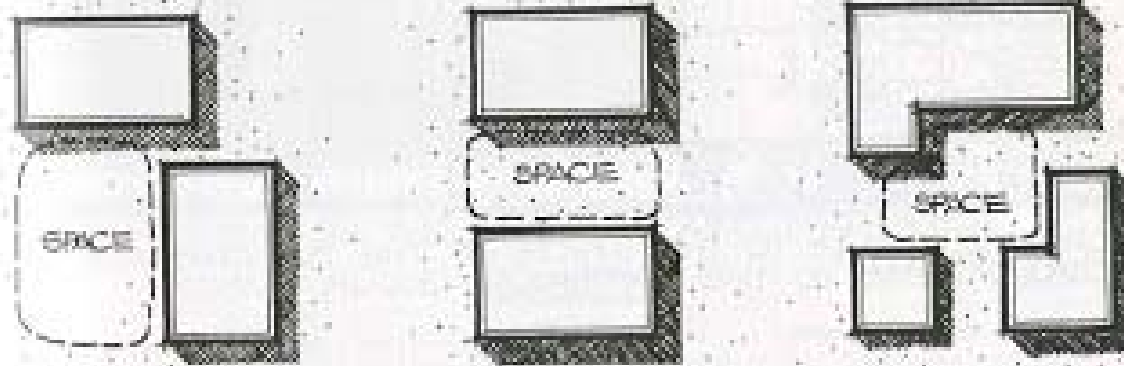

EXTERIOR SPACE IS CREATED WHEN TWO OR MORE BUILDINGS ARE CLUSTERED TOGETHER.

