

Architectural Modelling

How Importance?

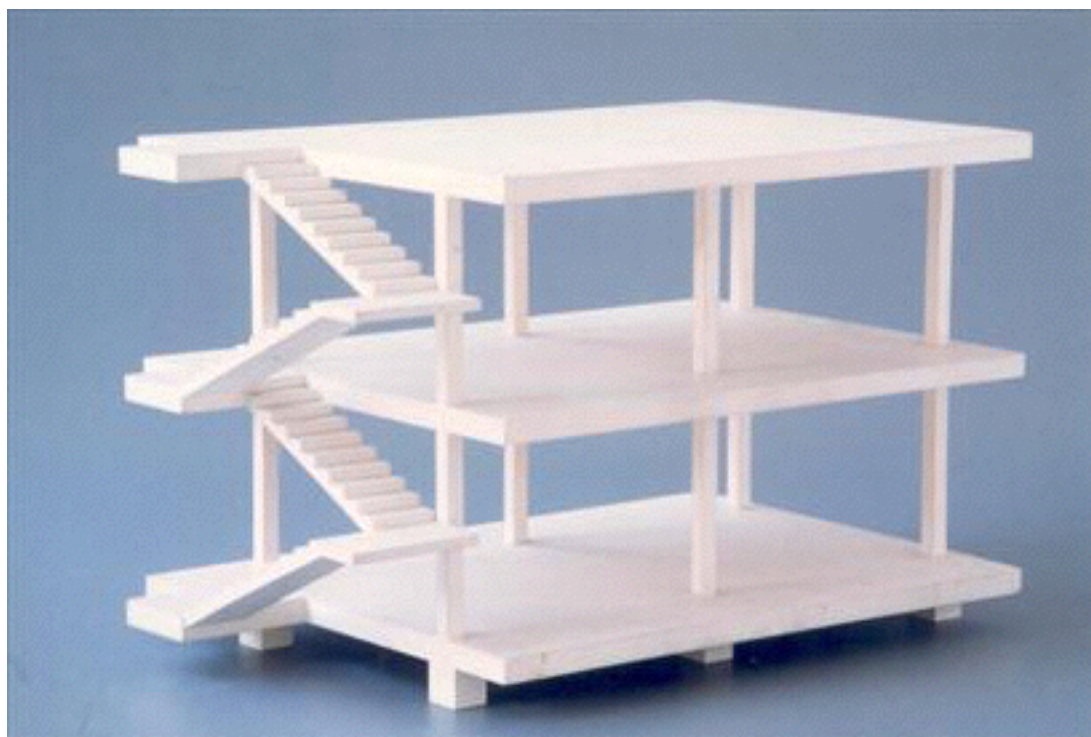

Dom-Ino House, Le Corbusier in 1914–1915

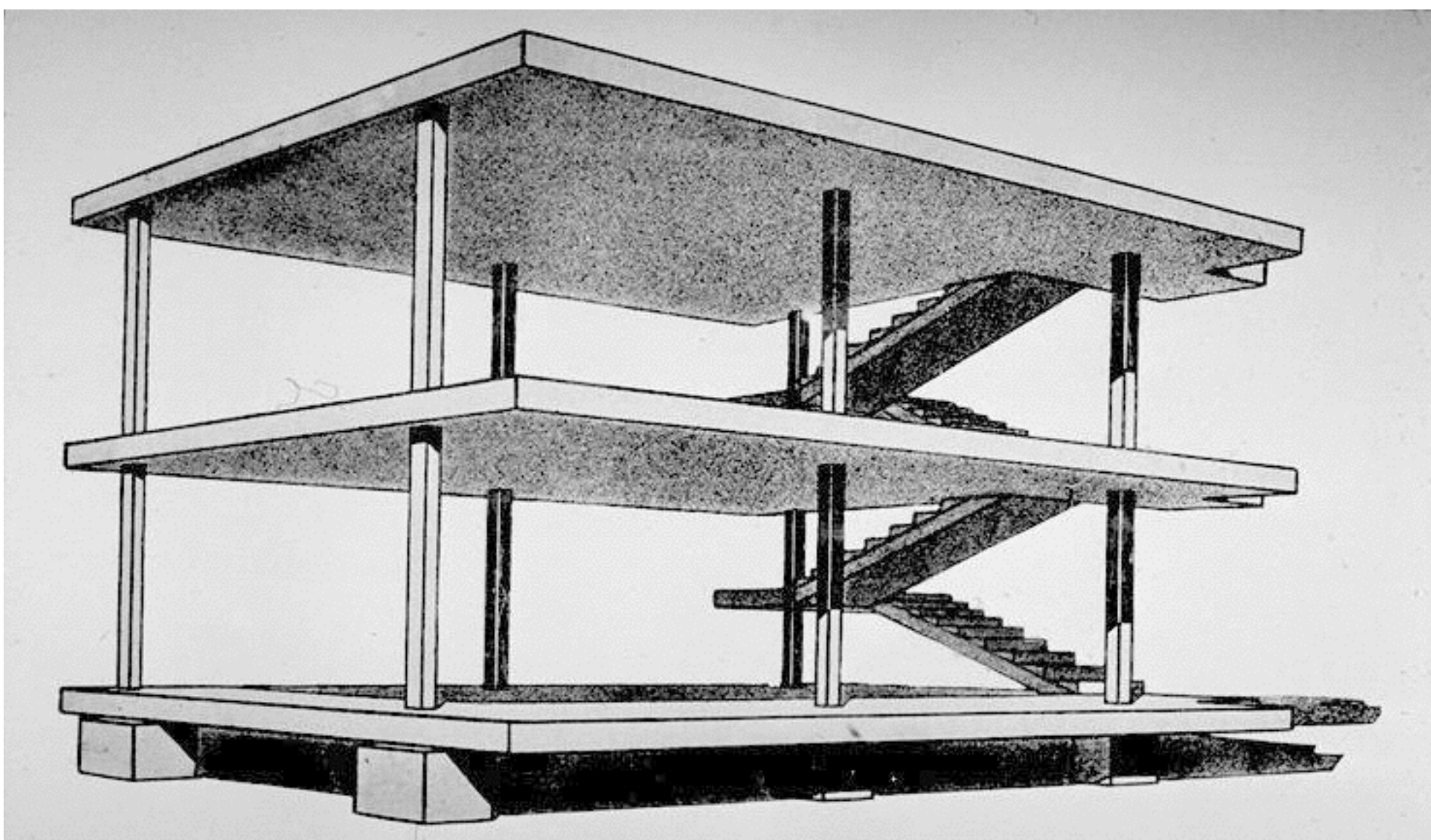
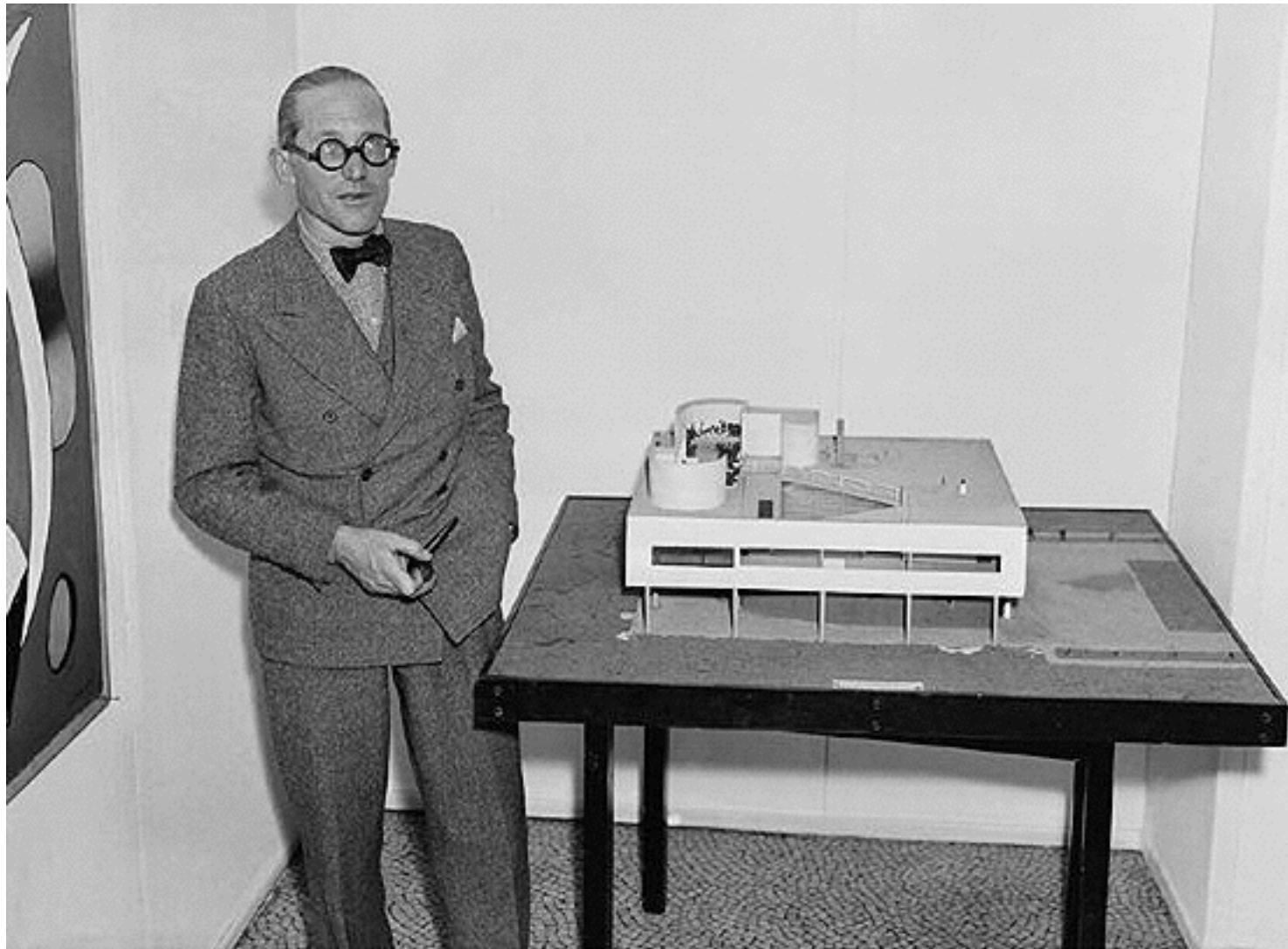

Le Corbusier with the model for Villa Savoye (1929)



Le Corbusier, Palace of Soviets, 1934

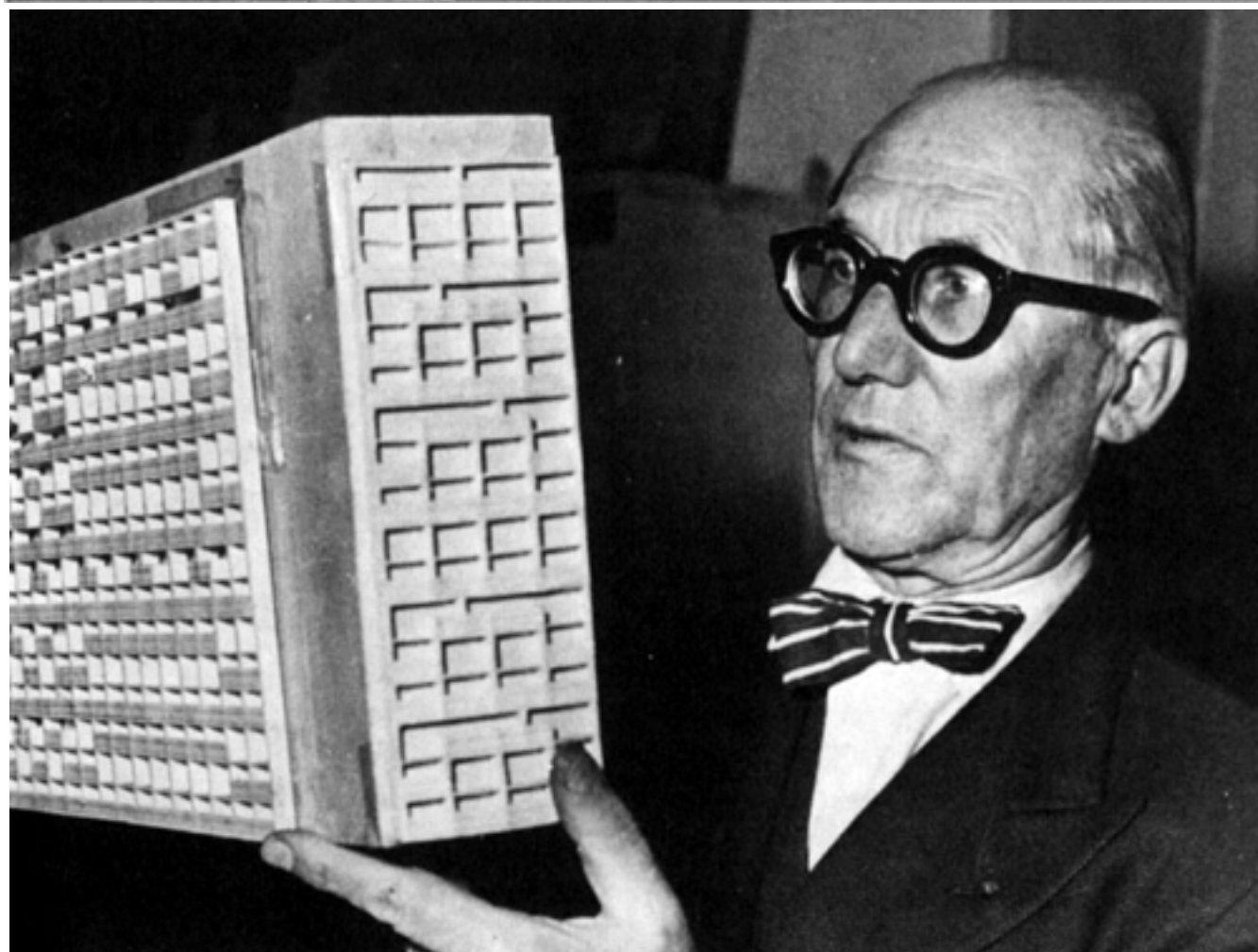

Le Corbusier

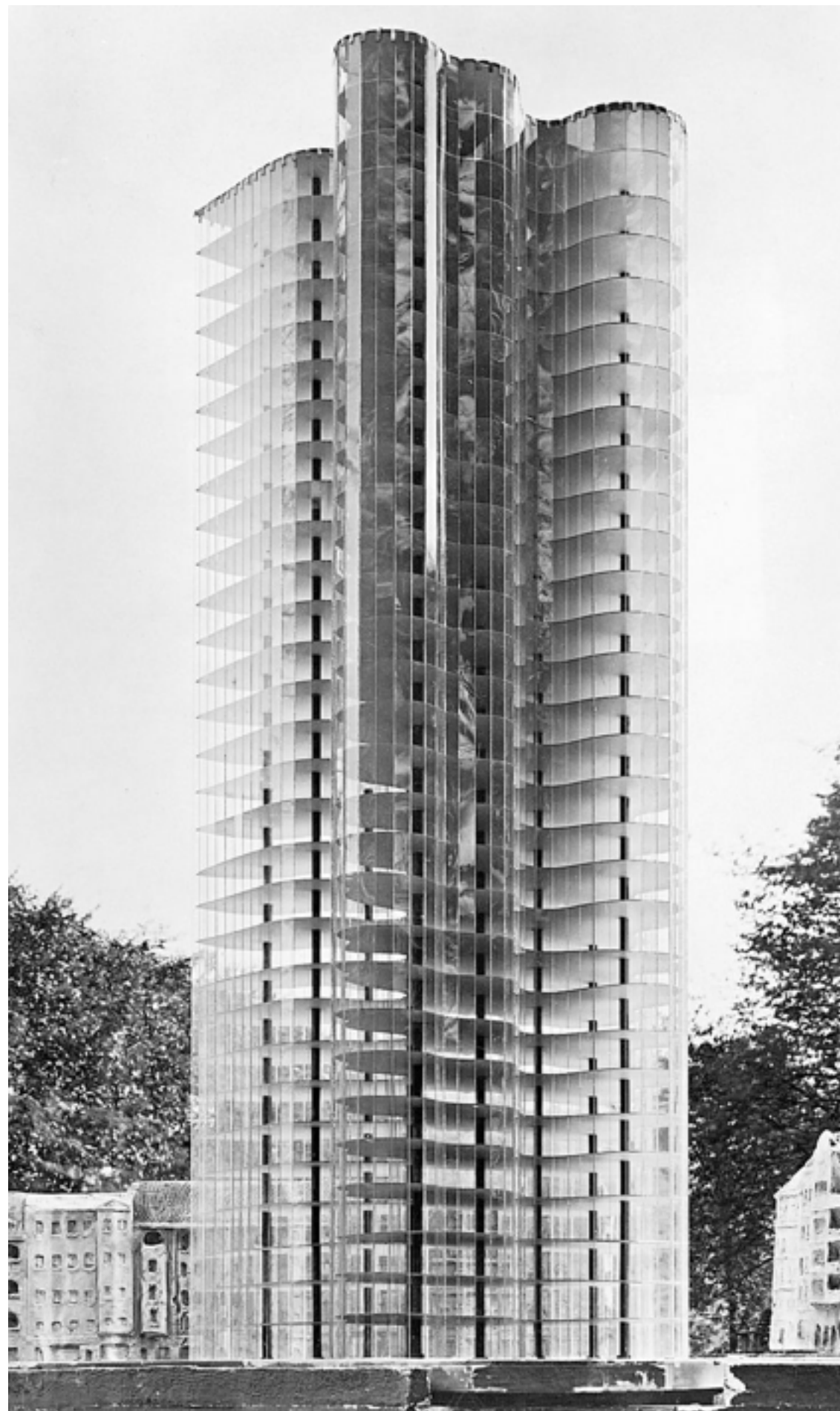

Ludwig Mies Van Der Rohe, model for a glass skyscraper, Berlin, Germany, 1922

Ludwig Mies Van Der Rohe, Seagram Building,
US, 1958

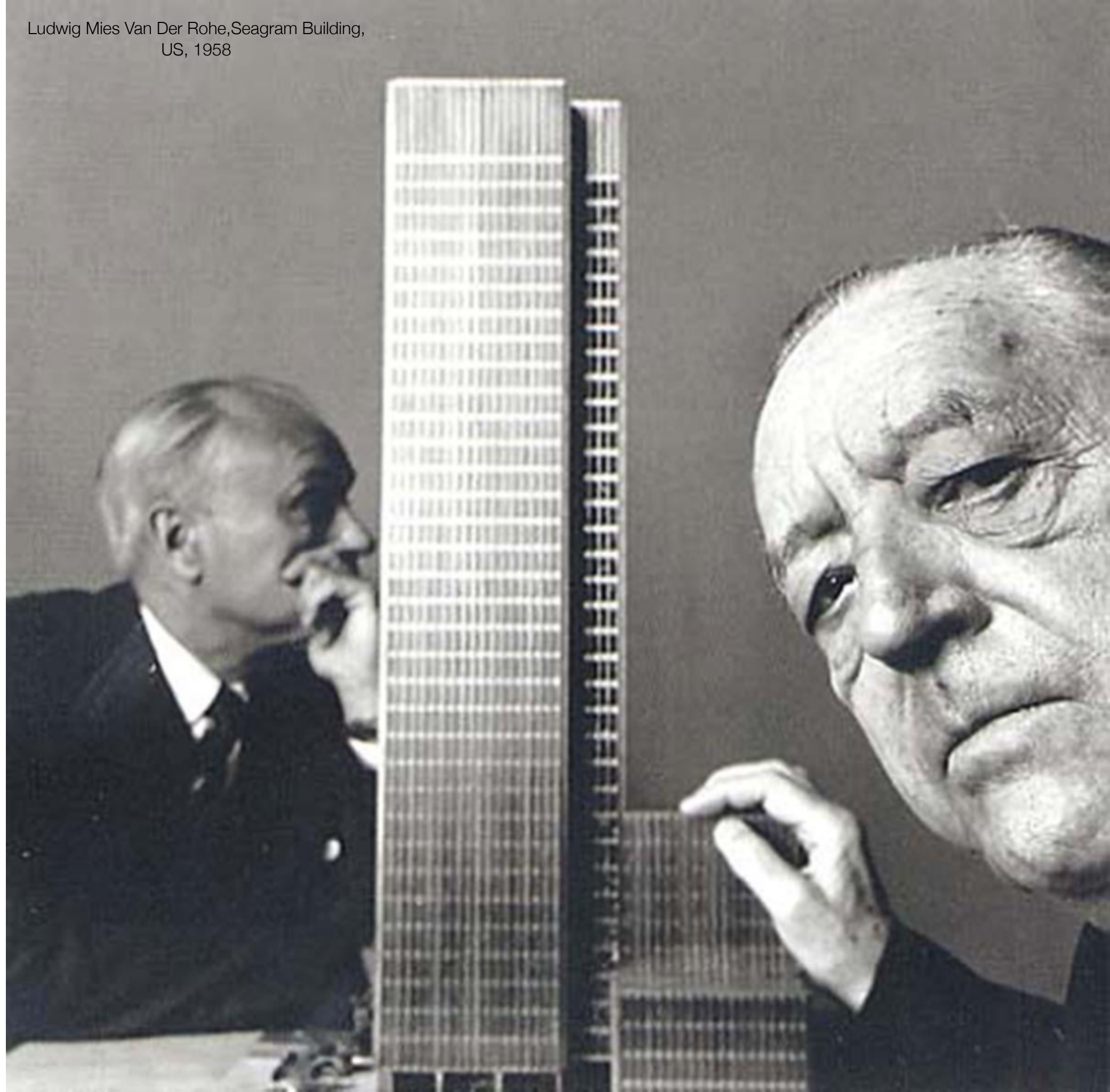



Ludwig Mies Van Der Rohe, Seagram Building,
US, 1958



Ludwig Mies Van Der Rohe, National Gallery
Building, Berlin, 1968



Ludwig Mies Van Der Rohe

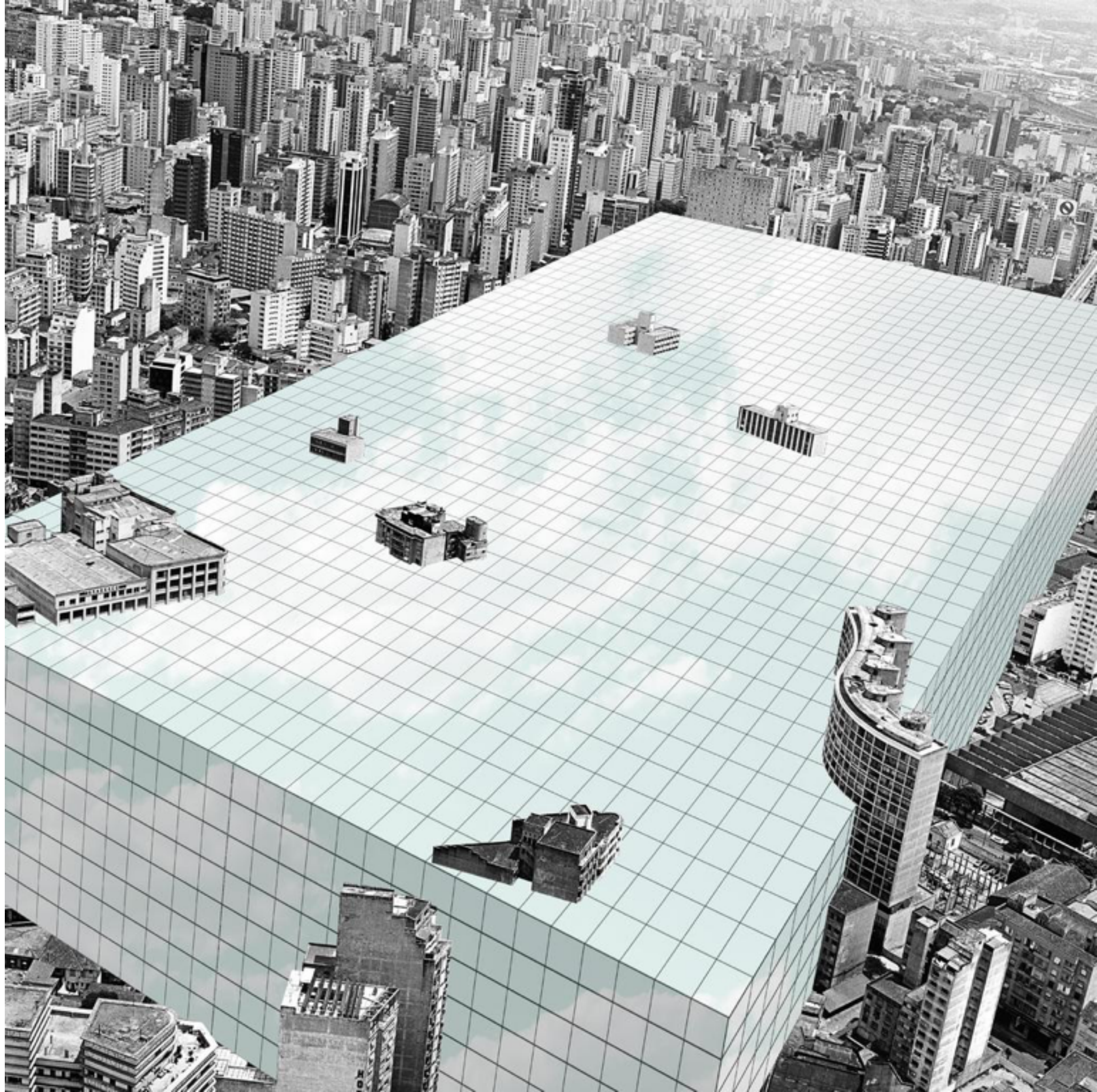

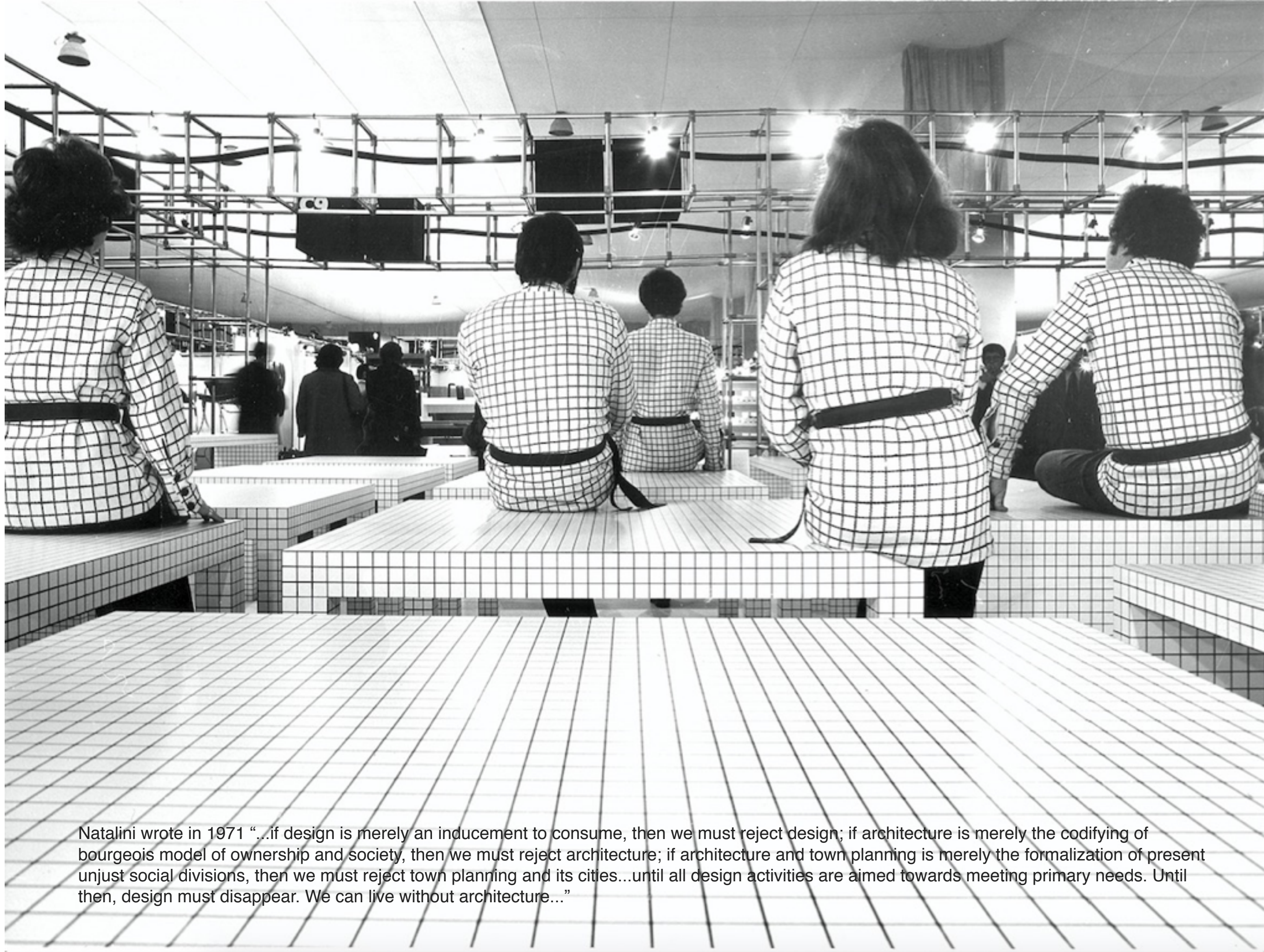

Natalini wrote in 1971 "...if design is merely an inducement to consume, then we must reject design; if architecture is merely the codifying of bourgeois model of ownership and society, then we must reject architecture; if architecture and town planning is merely the formalization of present unjust social divisions, then we must reject town planning and its cities...until all design activities are aimed towards meeting primary needs. Until then, design must disappear. We can live without architecture..."





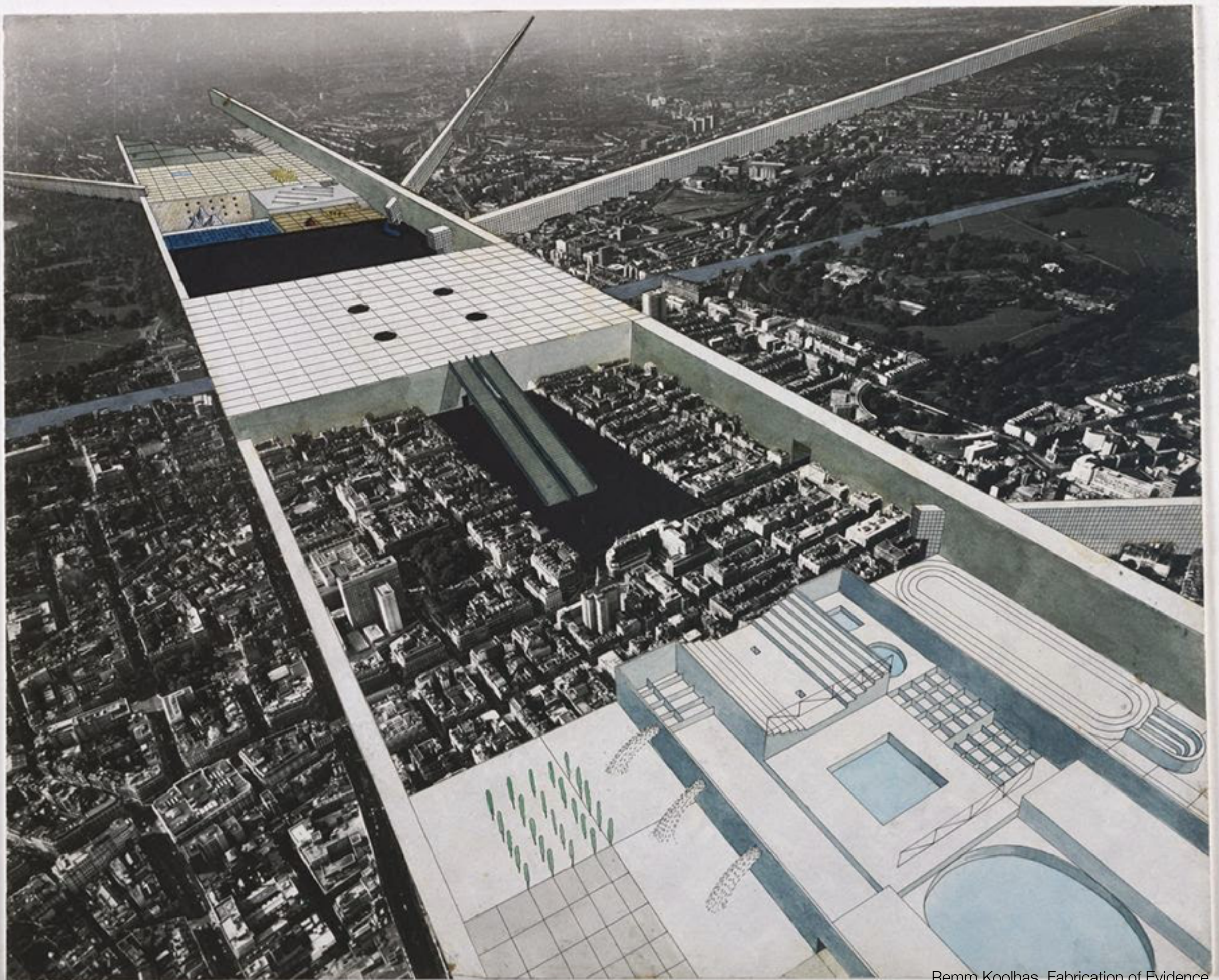

Rem Koolhaas, Fabrication of Evidence

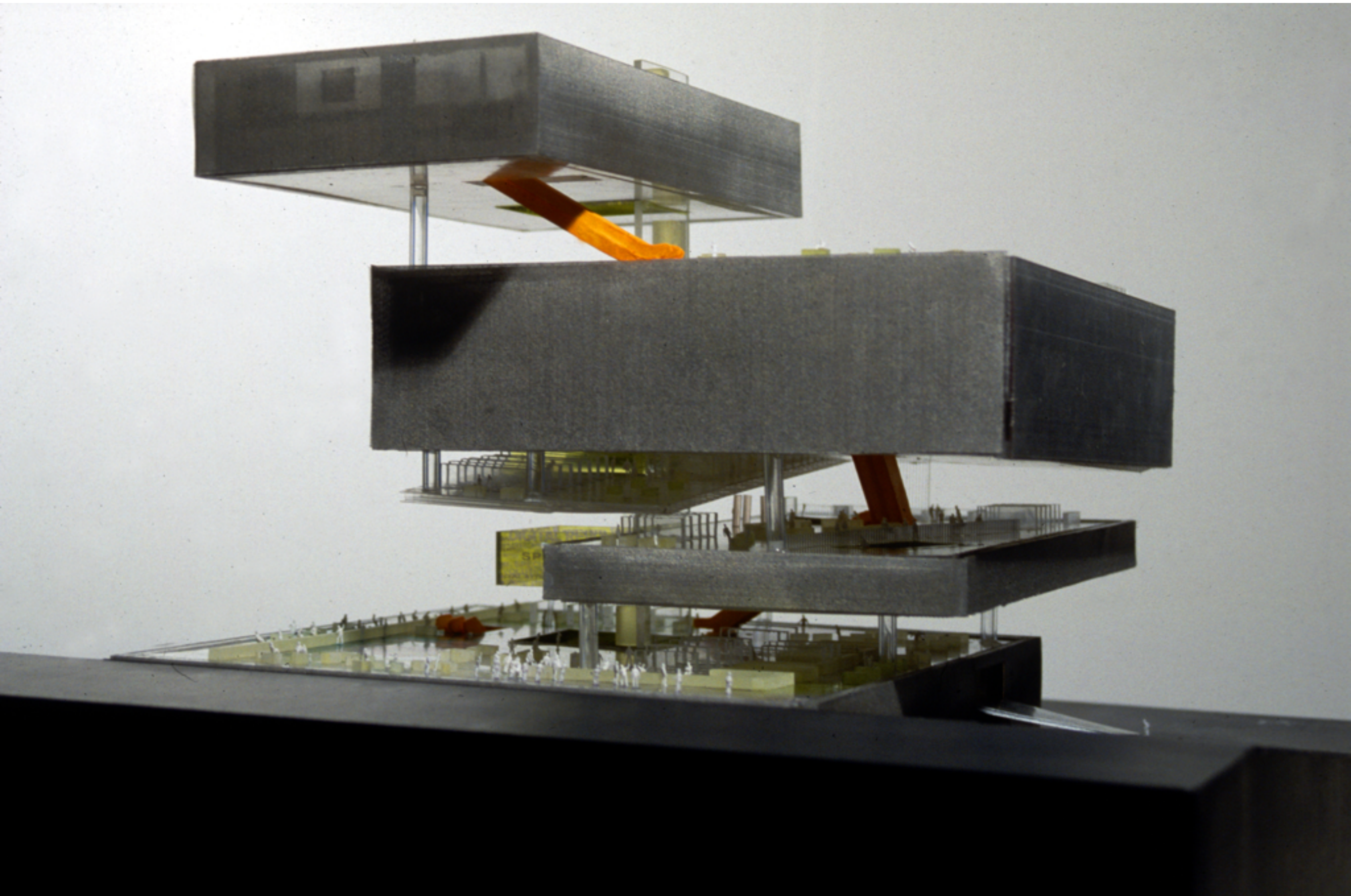

Rem Koolhaas, Seattle Library



Rem Koolhaas, Seattle Library

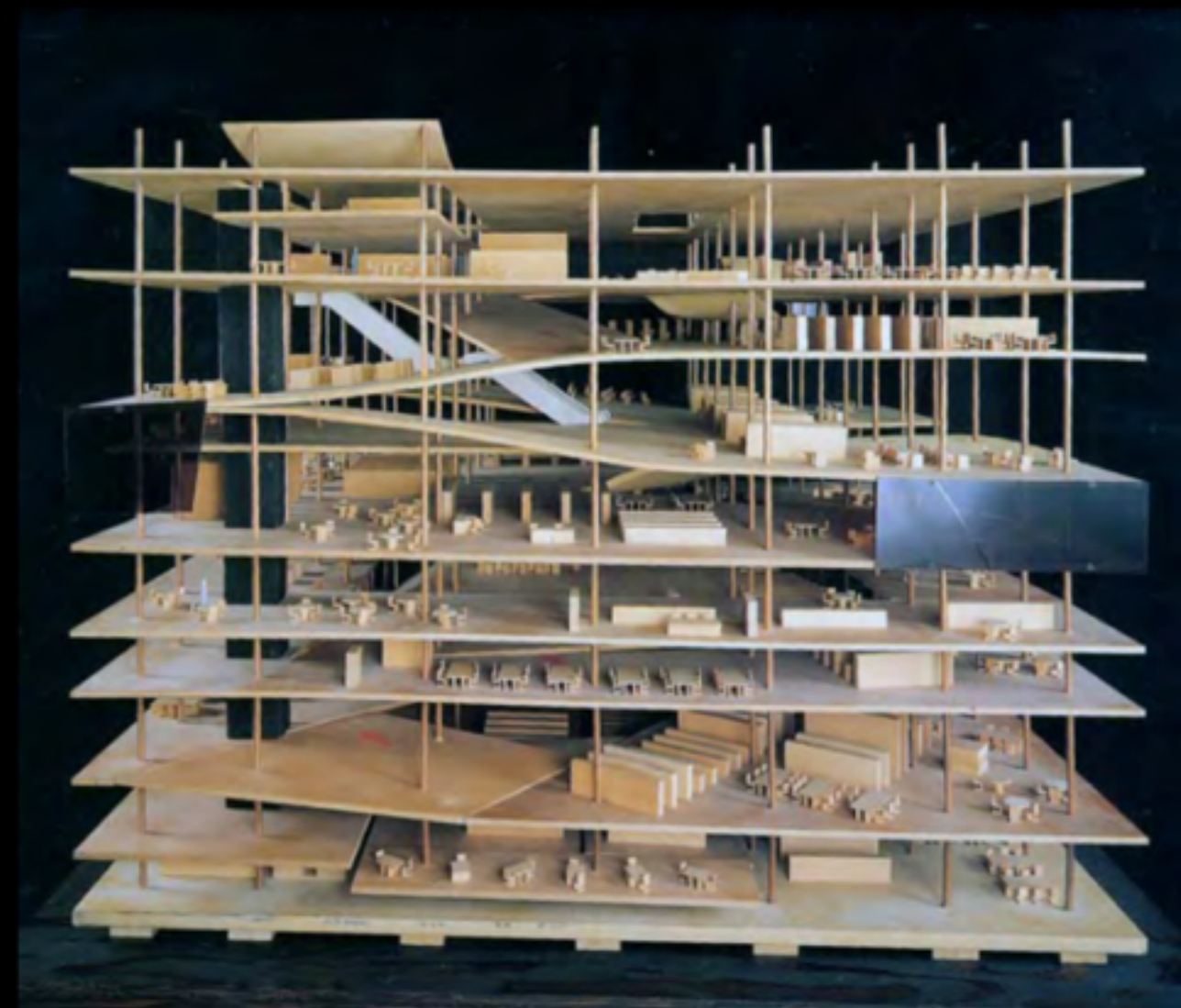
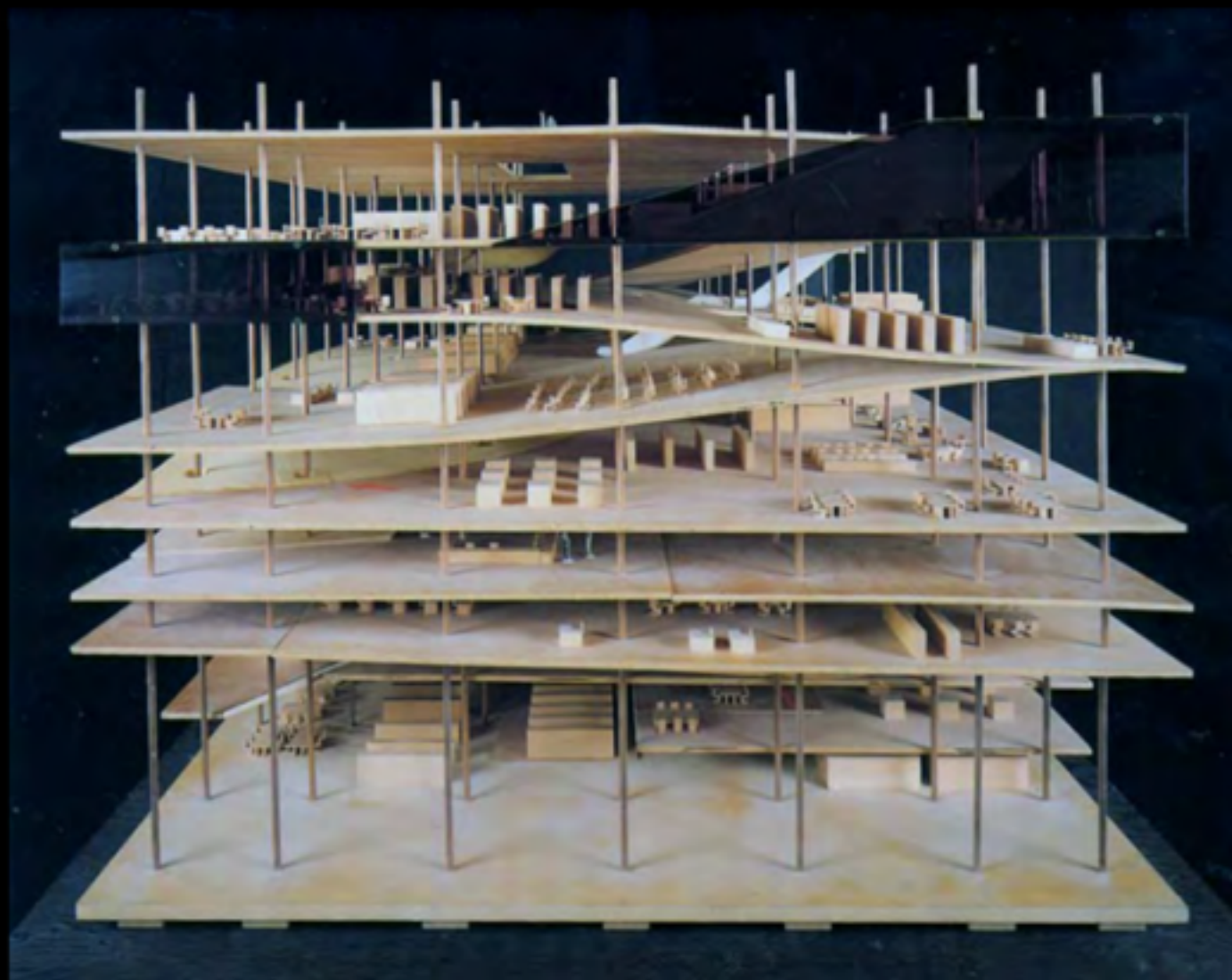

Rem Koolhaas, Paris Library

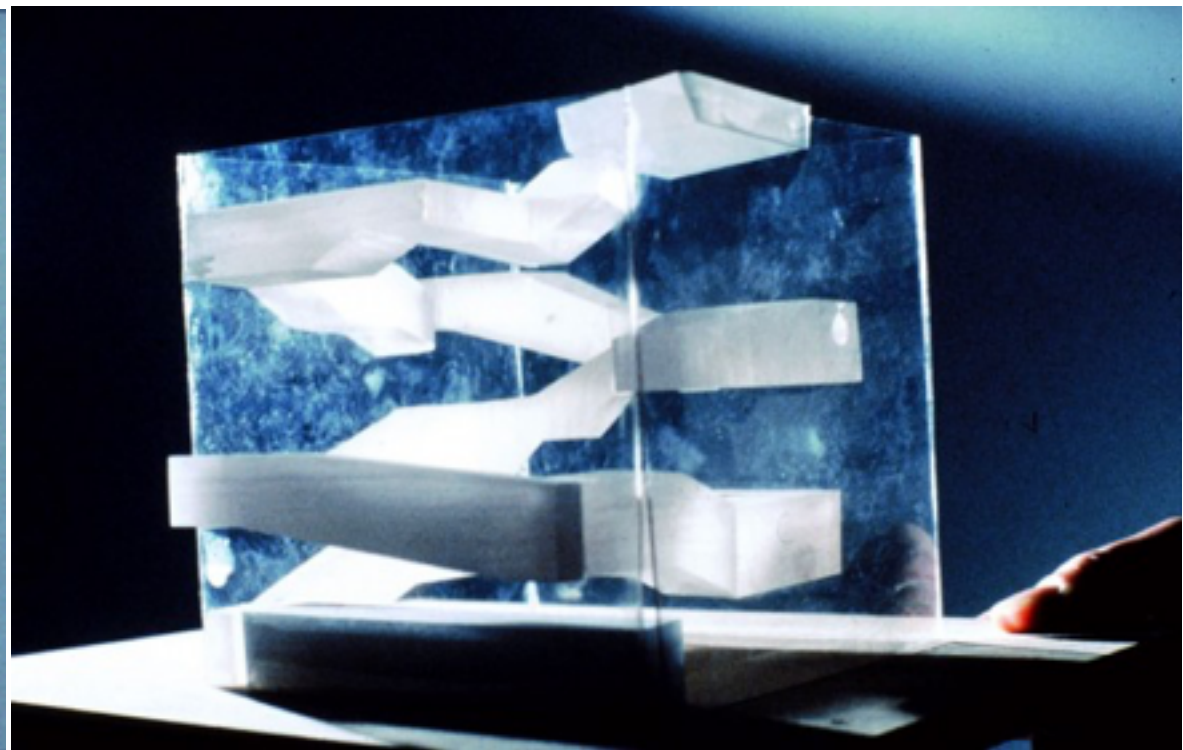
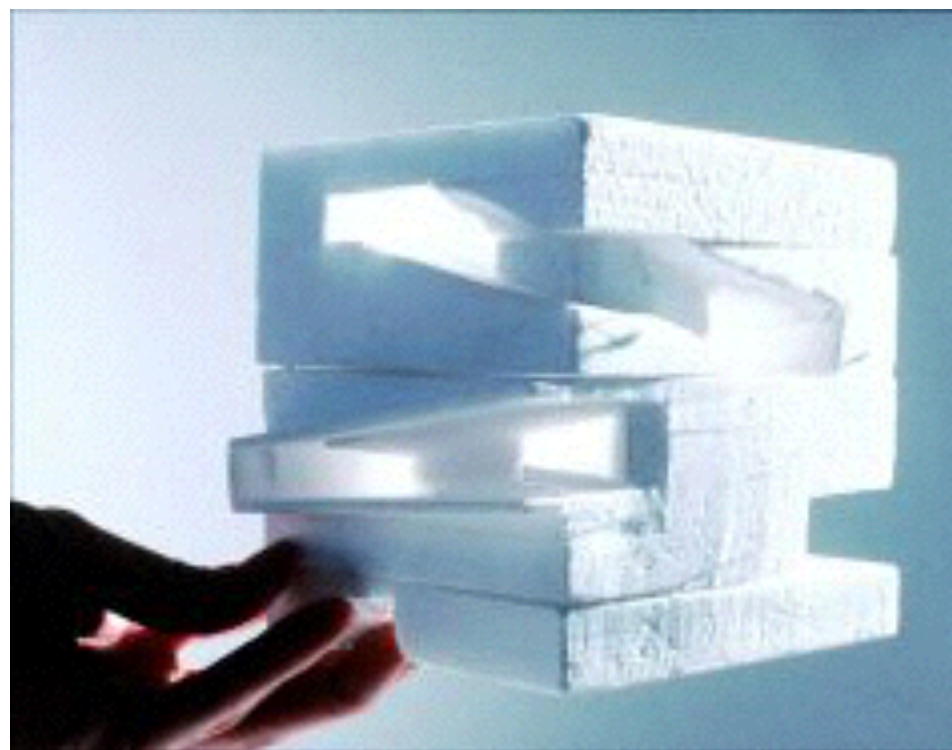





Zaha Hadid in her London office circa 1985

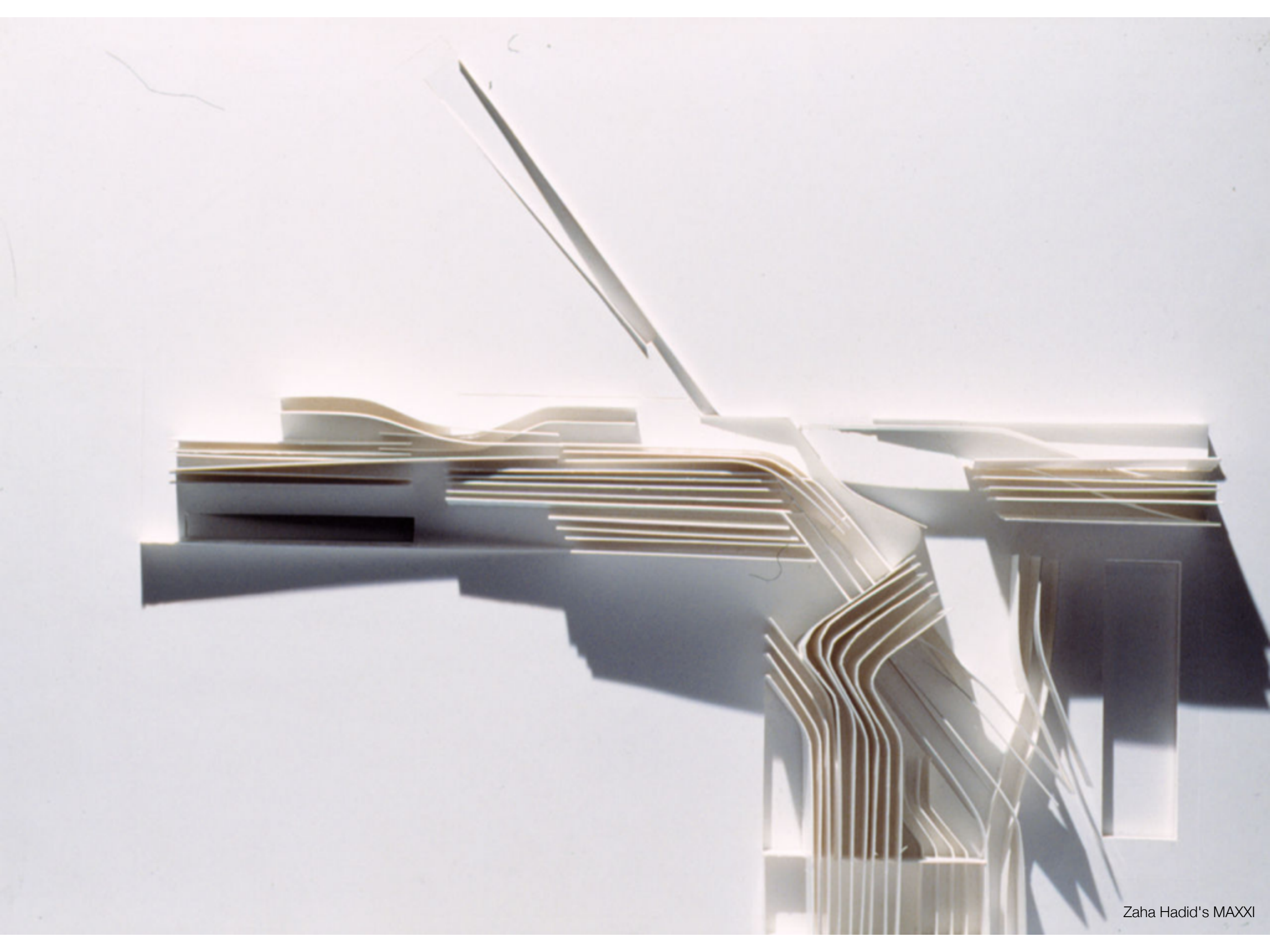

Zaha Hadid's MAXXI



Zaha Hadid Bogota Convention Centre

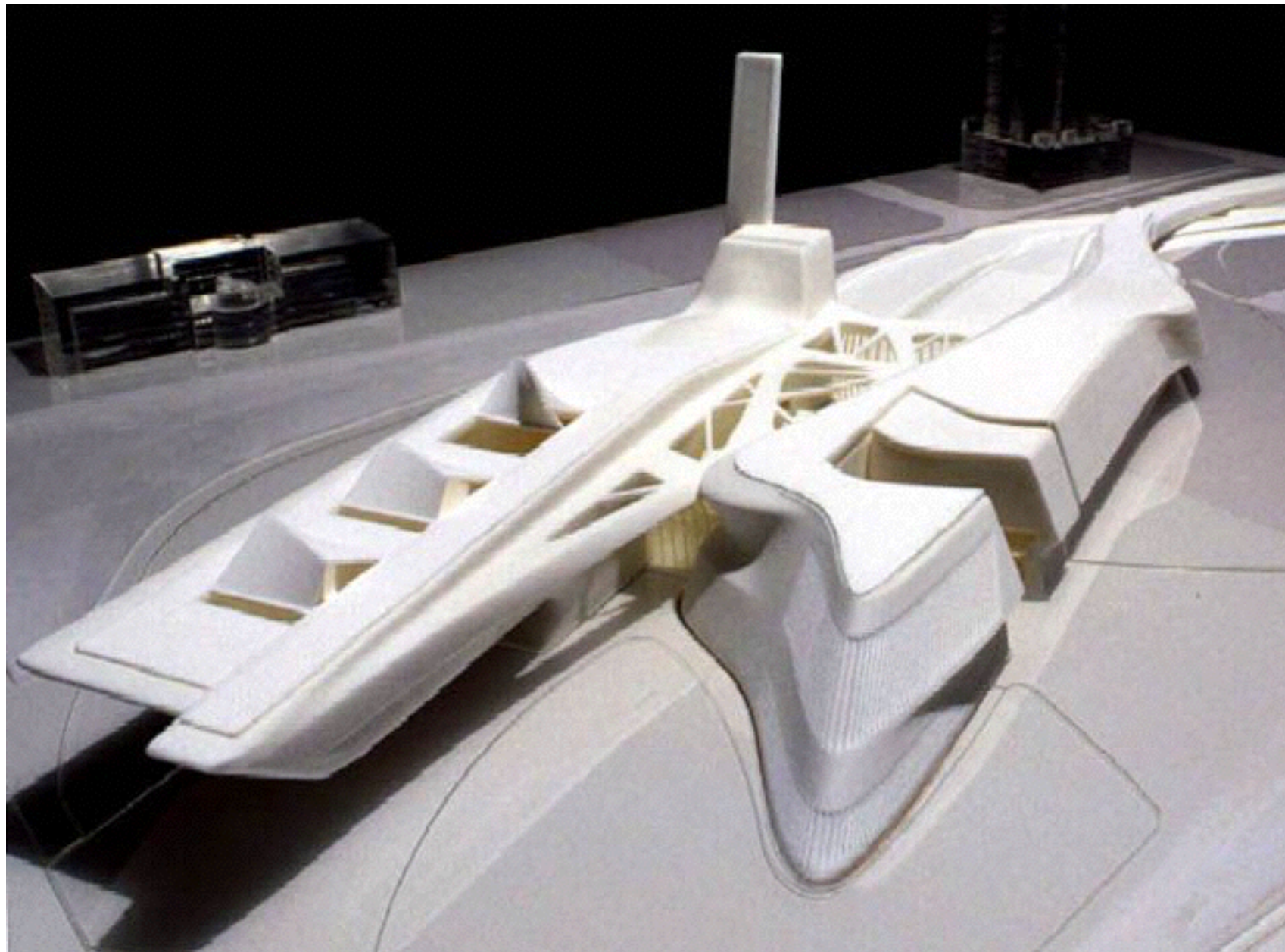

Zaha Hadid's model for the Guggenheim Museum Taichung, Republic of China